

UNIVERSITY OF

 SOUTHERN
INDIANA™

Knowledge for Life



A Guide for International Students



Welcome to the University of Southern Indiana

Thank you for your interest in the University of Southern Indiana (USI)! This viewbook is designed to help you explore your major of interest, acquaint you with the beautiful, vibrant USI campus and get you started on the next step of your educational journey.

As a student at USI, you will have the opportunity to work with your professors on research and creative projects to gain inspired perspectives and solve real-world challenges. Our professors are accessible, engaging and most importantly, committed to teaching. With our small classes and modern facilities, you will receive an excellent education at USI and a warm, friendly introduction to life in the United States.

We hope to welcome you to our community very soon!

If you would like further information about our programs, the application process or next steps, email us at intlprog@usi.edu.



9,300+

students enrolled

25

average class size

36|51

USI students come from 36 states and 51 countries.



80

degree programs

4

academic colleges

- College of Liberal Arts
- College of Nursing and Health Professions
- Pott College of Science, Engineering, and Education
- Romain College of Business



\$16,000

approximate annual tuition

1,400

acres of beautiful campus

USI offers suite-style residence halls and apartments for student housing.



90

percentage of graduates across all majors gain employment within one year in their field of study



TABLE OF CONTENTS

About USI.....	1
Academic excellence plus affordability	1
Natural beauty/modern facilities	1
Learner-centered approach.....	1
Things to know about studying at USI	2
Academic calendar	2
Credit hours.....	2
Grade point average	2
Core Curriculum.....	2
Tools for Success	3
Accreditation.....	3
Degree Programs.....	4
College of Business.....	8
College of Liberal Arts	10
College of Nursing and Health Professions.....	12
Pott College of Science, Engineering, and Education	14
Opportunities for Practical Experiences	15
Location is everything.....	16
Indiana	16
Evansville	16
Economy.....	16
Getting around the city	17
Climate	17
So much to enjoy.....	17
Admission procedures and deadlines	18
Undergraduate admission	18
Graduate admission	19
Test of English as a Foreign Language	19
Immigration policies.....	19
Transfer credit.....	19
Intensive English Program	20
Housing and Residence Life.....	21
Campus living.....	21
Campus housing styles	21
Housing amenities.....	21
Global community.....	22
Center for International Programs.....	23
Athletics	25
Getting involved on campus	26
Student life.....	26
Campus organizations.....	26
International Club	26
How to get to the University of Southern Indiana.....	27



17

NCAA Division II Great Lakes Valley Conference men's and women's sports teams

65+

countries to which USI offers study abroad opportunities

130+

student organizations

Apply online at [USI.edu/apply](https://www.usi.edu/apply).

If you have any questions, call the USI admission team at **800-467-1965** or **812-464-1765**.

Connect with USI:    



About USI

Academic excellence plus affordability

Established in 1965, the University of Southern Indiana is a comprehensive public university supported by the state of Indiana. In the United States, institutions supported by the state government offer the most affordable programs in higher education. USI offers a quality education at an excellent price.

A campus known for its natural beauty and modern facilities

USI offers a friendly atmosphere on a 1,400-acre campus in southwest Indiana. The University has 14 major buildings and provides modern apartments and suite-style housing for students living on campus.

One of the newest buildings is the University Center (UC), awarded the Association of College Unions International (ACUI) Facility Design Award of Excellence in 2012. The UC acts as an orienting feature of the campus, provides flexible gathering places for students and commemorates the role played by several area businesses in its use of materials and furnishings.

The Physical Activities Center, Recreation, Fitness and Wellness Center, University Center, outdoor playing fields and extensive walking and biking trails on campus allow students to experience a full range of activities that contribute to academic and personal growth.

Learner-centered approach

Over 9,300 students attend USI. More than 2,800 of those students live on campus. In fall of 2014, the University welcomed students from 36 other states within the United States, and 51 other nations.

USI's top priority is teaching undergraduate students. USI invests tuition dollars in knowledgeable and qualified professors who want to be in the classroom. Small classes encourage dialogue and interaction and allow professors to develop a working relationship with students.

At USI, theory and practical training are educational partners. The Carnegie Foundation for the Advancement of Teaching has given USI its Community Engagement classification. This recognizes USI's ongoing collaboration with the Tri-state community and beyond in curricular engagement, outreach and partnerships. Classroom lectures and presentations combine with extensive hands-on laboratory work, collaborative projects, service learning or other activities that simulate how professionals in the workplace do their jobs. Depending on the degree you are pursuing, student teaching, clinical experience, undergraduate research or other practical experiences will be part of your education.

Average class size: 25 students

Things to know about studying at USI

Academic calendar

The academic year is organized into two semesters. The fall semester begins in late August and runs through mid-December; the spring semester begins in January and ends in May.

From May through August, the University has three five-week summer sessions. Students can enroll in one or two courses during each summer session in order to complete their degree in less than four years or to take courses they could not take during the regular academic year. International students on F-1 or J-1 visas are not required to enroll in summer courses, but many students complete at least one summer term.

Credit hours

Most courses meet three or four hours per week and therefore earn three or four credit hours. To remain full-time each semester, an international undergraduate must enroll in a minimum of 12 credit hours, and a graduate student must enroll in nine credit hours. A typical bachelor's degree requires 120 credit hours. A master's degree is generally 33 credit hours and can be completed in two years. While international undergraduates must take a minimum of 12 credit hours to maintain F-1 or J-1 status, students typically take 15-17 credit hours per semester in order to graduate in four years.

Grade point average

A student's academic performance is measured by the grade point average (GPA). USI uses letter grades (A, B, C, D and F). The letter grades a student earns are converted to numerals with A (excellent) equal to 4 and so on down to F (failing) equal to 0. The numerals representing the student's grade in each course are added and averaged to determine the student's GPA for that semester. A cumulative average also will be calculated.

Core Curriculum—a broad educational foundation

Like most American universities, the University of Southern Indiana uses a liberal arts and science curriculum as the foundation for all programs. All students pursuing bachelor's degrees must complete the University Core 39 Curriculum regardless of their major.

The core includes courses in composition/speech, mathematics, ethics, the arts, health/fitness, history, individual development/social behavior, science, western culture, language and other topics.

Most students complete a bachelor's degree in four years. During the first two years, they take most of the Core 39 Curriculum courses. Then they focus more narrowly on courses in their chosen major during the next two years.





TOOLS FOR ACADEMIC SUCCESS

We are committed to your success!
USI offers:

Free tutoring for a variety of subjects

Writer's Room to help students with writing assignments

Supplemental instruction in key courses

Courses to improve study habits and help select a major

Workshops that focus on skills and strategies for lifelong learning

Academic advising by professors and professional advisors

Accreditation

- Higher Learning Commission, a Commission of the North Central Association
- Accreditation Board for Engineering and Technology (ABET)
- Association to Advance Collegiate Schools of Business (AACSB)
- Association of University Programs in Health Administration Certification
- Accreditation Council for Occupational Therapy Education
- American Chemical Society
- Commission on Accreditation of Allied Health Education Programs
- Commission on Collegiate Nursing Education
- Commission on Dental Accreditation; American Dental Association
- Commission on Accreditation for Respiratory Therapy
- Council on Social Work Education
- Joint Review Committee on Education in Radiologic Technology
- National Association for the Education of Young Children
- National Association of Schools of Art and Design
- National Council for Accreditation of Teacher Education



Bachelor Degree Programs

ROMAIN COLLEGE OF BUSINESS

Accounting and Professional Services
 Business Administration

- Entrepreneurship/Small Business
- General Business
- International Business

 Computer Information Systems
 Computer Science
 Economics
 Finance
 Management
 Marketing

POTT COLLEGE OF SCIENCE, ENGINEERING, AND EDUCATION

Advanced Manufacturing
 Biochemistry
 Biology
 Biophysics
 Chemistry
 Engineering

- Civil
- Electrical and Computer
- Industrial and Manufacturing
- Mechanical
- Mechatronics

 Environmental Science
 Exercise Science

- Pre-Occupational Therapy
- Pre-Physical Therapy
- Strength and Conditioning

 Geology
 Industrial Supervision
 Kinesiology
 Sport Management

EDUCATION DEGREES

Chemistry
 Early Childhood (Non-Teaching)
 Early Childhood Education
 Elementary Education
 Mathematics

- Actuarial Science

 Mathematics Teaching*
 Science Teaching*
 Special Education

*Secondary Education
 – Denotes area of emphasis





Bachelor Degree Programs (cont.)

COLLEGE OF LIBERAL ARTS

- Anthropology
- Art
 - Art History
 - Graphic Design
 - Illustration
 - Interactive Media Design
 - Photography
 - Studio Art
- Communication Studies
- Criminal Justice Studies
- English
 - Creative Writing
 - Literature
 - Rhetoric and Writing
- English Teaching*
- French Studies
- French Studies Teaching*
- German Studies
- German Studies Teaching*
- History
- International Studies
- Journalism
- Philosophy
- Political Science
- Psychology
- Public Relations and Advertising
- Radio and Television
- Social Work
- Sociology
- Spanish Studies
- Spanish Studies Teaching*
- Theatre Arts
- Visual Art Teaching*

COLLEGE OF NURSING AND HEALTH PROFESSIONS

- Dental Hygiene
- Food and Nutrition
 - Dietetics
 - Food Service Management
 - Nutrition and Wellness
- Health Services
 - Generalist
 - Gerontology
 - Health Administration
 - Health Promotion and Worksite Wellness
 - Long-Term Care Administration
 - Public Health
- Nursing
- Radiologic and Imaging Sciences
 - Clinical Education
 - Diagnostic Medical Sonography
 - General Sonography and Echocardiography
 - General Sonography and Vascular
 - Management
 - MRI and CT
- Respiratory Therapy

PRE-PROFESSIONAL PROGRAMS

- (Biology/Chemistry major)
- Pre-Chiropractic
- Pre-Dentistry
- Pre-Forestry
- Pre-Medical Technology
- Pre-Medicine
- Pre-Occupational Therapy
- Pre-Optometry
- Pre-Osteopathy
- Pre-Pharmacy
- Pre-Physical Therapy
- Pre-Physician Assistant
- Pre-Podiatry
- Pre-Veterinary
- Pre-Wildlife Biology
- Pre-Zoology

BACHELOR OF PROFESSIONAL STUDIES

- Students must be over 25 years of age.*
- Applied Studies
- Individual Studies

Associate Degree Programs

ROMAIN COLLEGE OF BUSINESS

Business

POTT COLLEGE OF SCIENCE, ENGINEERING, AND EDUCATION

Early Childhood Education

COLLEGE OF LIBERAL ARTS

Social Science

COLLEGE OF NURSING AND HEALTH PROFESSIONS

Dental Assisting

Occupational Therapy Assisting

Certificate Programs

Dental Assisting Certificate

Post-Baccalaureate Certificate in
Professional Accountancy

Post-Baccalaureate Certificate in
Computer Information Systems

Masters Programs

Business Administration

Communication

Education

English[†]

Health Administration

Industrial Management[†]

Liberal Studies

Occupational Therapy

Public Administration

Nursing[†]

Social Work

Doctoral Programs

Doctor of Nursing Practice[†]

*Secondary Education

†Part-time or online and would not qualify for
a student visa.

–Denotes area of emphasis



Apply online at **USI.edu/apply**





SOFTWARE INTERFACE

(INPUT)

① VARIABLES

- LASER
- SYSTEM
- T. KINET
- ENVIRONMENT

④ THREE

+
/ITERATION

MUSIC MINOR (M) *
Comp. M...
Fast Mapping (F) *
Radio Station (R) *
S...
2...
3...
4...
5...
6...
7...
8...
9...
10...
11...
12...
13...
14...
15...
16...
17...
18...
19...
20...
21...
22...
23...
24...
25...
26...
27...
28...
29...
30...
31...
32...
33...
34...
35...
36...
37...
38...
39...
40...
41...
42...
43...
44...
45...
46...
47...
48...
49...
50...

Key: Coops, Cave, Path, Cache, Mine
Laser clock, airport landing

MINOR
MUSIC

Security → ...

Security Viewing for ...
Detects ...

Security/Location ...
TOWER ...



Romain College of Business

BACHELOR DEGREES

Accounting and Professional Services
 Business Administration
 – Entrepreneurship/Small Business
 – General Business
 – International Business
 Computer Information Systems
 Computer Science
 Economics
 Finance
 Management
 Marketing

ASSOCIATE DEGREE

Business

MASTER DEGREES

Business Administration

– Denotes area of emphasis

As one of only 15 percent of the world's business schools with the Association to Advance Collegiate Schools of Business (AACSB) accreditation, the **Romain College of Business** is dedicated to your development, both academically and professionally. The College's AACSB accreditation represents the highest standard of achievement for business schools worldwide. The Romain College of Business is housed in the 76,800-square-foot Business and Engineering Center.



Experienced and diverse faculty will expose you to a wealth of global views. They not only teach, but also are active in scholarly pursuits, professional organizations and serve as business consultants. USI's midwest location opens many doors, providing opportunities to gain workplace experience through internships at regional and global corporations and through partnerships with business leaders, alumni and others. The academic environment you'll find at USI is challenging, yet nurturing, and inspires lifelong learning while preparing you to succeed in an increasingly global business climate that continues to become more and more diverse and technologically complex.



POINTS OF PRIDE

USI's Institute of Management Accountants (IMA) Student Chapter received a Gold Certificate of Excellence, the highest level of recognition, in three of the last four years.

USI's Business and Engineering Center offers cutting-edge learning spaces, including an experimental economics laboratory, advanced sales management laboratory and an interactive stock trading wall.

The Romain College of Business Investment Accounting Accelerator offers cutting-edge technology that gives students hands-on experience.



College of Liberal Arts

BACHELOR DEGREES

Anthropology

Art

- Art History
- Graphic Design
- Illustration
- Interactive Media Design
- Photography
- Studio Art

Communication Studies

Criminal Justice Studies

English

- Creative Writing
- Literature
- Rhetoric and Writing

English Teaching*

French Studies

French Studies Teaching*

German Studies

German Studies Teaching*

History

International Studies

Journalism

Philosophy

Political Science

Psychology

Public Relations and Advertising

Radio and Television

Social Work

Sociology

Spanish Studies

Spanish Studies Teaching*

Theatre Arts

Visual Art Teaching*

ASSOCIATE DEGREE

Social Science

MASTER DEGREES

Communication (M.A.C.)

English (M.A.E.)†

Liberal Studies (M.A.L.S.)

Public Administration (M.P.A.)

Social Work (M.S.W.)

*Secondary Education

†Part-time or online and would not qualify for a student visa.

-Denotes area of emphasis

Programs offered by USI's **College of Liberal Arts** provide the knowledge and skills you need to think critically, communicate effectively and solve complex problems in the world around you. More than 30 majors and emphases across 11 academic departments will equip you with essential skills employers seek, and prepare you to flourish in any environment. Internships, student organizations and study abroad programs are available in most majors, allowing you to gain experience in your field and broaden understanding of a diverse and changing world. Our programs, taught by highly qualified faculty in the arts, humanities and social sciences, will stimulate creativity and shape you into a global citizen.



POINTS OF PRIDE

USI Performing Arts offers an educational experience few undergraduate programs can match. Many students have the opportunity to work with professional artists through a direct relationship with New Harmony Theatre, a nationally-respected regional Equity theatre. The USI Performance Center opened in spring of 2015.

The Shield, USI's student newspaper, won Division II Newspaper of the Year for the second year in a row.

The Edge/WSWI, USI radio, won two national awards from the 2014 BEA Festival of Arts, including second place for On Air Personality and honorable mention for Radio Newscast.

The College operates four academic centers: Center for Communal Studies, Center for Interdisciplinary Studies, Center for Social Justice Education and the Scripps Howard Center for Media Studies



College of Nursing and Health Professions

BACHELOR DEGREES

- Dental Hygiene
- Food and Nutrition
 - Dietetics
 - Food Service Management
 - Nutrition and Wellness
- Health Services
 - Generalist
 - Gerontology
 - Health Administration
 - Health Promotion and Worksite Wellness
 - Long-Term Care Administration
 - Public Health
- Nursing
- Radiologic and Imaging Sciences
 - Clinical Education
 - Diagnostic Medical Sonography
 - General Sonography and Echocardiography
 - General Sonography and Vascular
 - Management
 - MRI and CT
- Respiratory Therapy

ASSOCIATE DEGREES

- Dental Assisting
- Occupational Therapy Assistant

MASTER DEGREES

- Health Administration
- Nursing †
- Occupational Therapy

DOCTORAL DEGREE

- Nursing Practice †

*Secondary Education

†Part-time or online and would not qualify for a student visa.

–Denotes area of emphasis

The **College of Nursing and Health Professions** offers 10 academic programs providing challenging and innovative learning experiences, excellent clinical and internship opportunities and a wide array of activities that allow you to engage with the community. More than 800 designated healthcare facilities across the United States, and internationally, provide real-life clinical practice experience. You'll interact with our diverse and highly experienced faculty, many with specialized credentialing in their professions.



Graduates who earn degrees offered by the College consistently score above state and national averages on credentialing examinations. As a result, many report employment immediately upon graduation and experience success in their professional fields.

POINTS OF PRIDE

Interprofessional education activities are available, including a state-of-the-art Simulation Center that provides students in multiple disciplines the opportunity to participate in collaborative clinical experiences.

The College is awarded more than \$1 million annually from local, state and national grants.

The College established three community health centers at Lodge, Glenwood and Cedar Hall. The inner-city primary care nursing-managed clinics are designed to increase community healthcare services.

The College implemented Designated Education Units in St. Mary's Medical Center and Deaconess Health System, offering an innovative clinical learning environment for multiple disciplines.



Admission requirements and application deadlines are available on the College of Nursing and Health Professions website at USI.edu/health. Additional application requirements vary by program. For example, undergraduate students seeking a degree in Nursing must apply for admission to the program upon completion of prerequisite courses.



Pott College of Science, Engineering, and Education

BACHELOR DEGREES

Advanced Manufacturing
 Biochemistry
 Biology
 Biophysics
 Chemistry
 Chemistry Teaching
 Early Childhood (Non-Teaching)
 Early Childhood Education
 Elementary Education
 Engineering
 – Civil
 – Electrical and Computer
 – Industrial and Manufacturing
 – Mechanical
 – Mechatronics
 Environmental Science
 Exercise Science
 – Pre-Occupational Therapy
 – Pre-Physical Therapy
 – Strength and Conditioning
 Geology
 Industrial Supervision
 Kinesiology
 Mathematics
 – Actuarial Science
 Mathematics Teaching*
 Science Teaching*
 Special Education
 Sport Management

ASSOCIATE DEGREE

Early Childhood Education

MASTER DEGREES

Education
 Industrial Management†
 Sport Management

PRE-PROFESSIONAL PROGRAMS

Students who aspire to professional careers requiring additional training beyond the bachelor's degree usually major in biology, biochemistry, or chemistry, though other majors are possible. Pre-professional curricula (which are not themselves majors) are available in the areas listed below:

Pre-Chiropractic
 Pre-Dentistry
 Pre-Forestry
 Pre-Medical Technology
 Pre-Medicine
 Pre-Occupational Therapy
 Pre-Optometry
 Pre-Osteopathy
 Pre-Pharmacy
 Pre-Physical Therapy
 Pre-Physician Assistant
 Pre-Podiatry
 Pre-Veterinary
 Pre-Wildlife Biology
 Pre-Zoology

*Secondary Education

†Part-time or online and would not qualify for a student visa.

–Denotes area of emphasis

USI's Pott College of Science, Engineering, and Education

helps you explore the latest scientific, mathematical, technical and education knowledge, while experiencing hands-on training through field work, student teaching, research and community outreach. Our state-of-the-art equipment, instrumentation and advanced manufacturing machinery for science and engineering is current and comprehensive. Innovation, like the Children's Learning Center for early childhood education majors, gives you the knowledge you'll need to succeed in a competitive job market. Through a strong partnership with USI's Romain College of Business, you'll follow the development of innovative ideas from lab testing to market research. Our ongoing relationships with local schools and partnerships with internationally renowned corporations provide real-world opportunities, experiences and professional development, while strengthening campus and community ties.



POINTS OF PRIDE

Our Applied Engineering Center features equipment found nowhere else in the country, and is a learning laboratory for students in engineering, advanced manufacturing and industrial supervision programs.

In the last five years, the College has received more than \$8 million in external support, including grants and contracts.

Pott College houses the Southwest Indiana Science, Technology, Engineering and Mathematics Resource Center (SwISTEM).

The College received over \$850,000 for the Teaching Eagles Scholarship Program to recruit and retain STEM educators.



Opportunities for Practical Experiences

USI encourages undergraduates to engage in practical training as well as increase their theoretical knowledge.

- The Office of Career Services and Placement assists students in arranging internships that give graduates an edge when they join the workforce.
- Endeavor! Awards for Research and Creativity are awarded in amounts of up to \$4,000 to encourage student participation in research and presentation.
- The Honors Program offers grants to study abroad, research opportunities, close contact with professors and residence in the Honors Living-Learning Community.
- The Service Learning Program at USI coordinates community-based service experiences that teach social responsibility and service, develop academic and leadership skills and make students more marketable upon graduation.
- The Center for International Programs and Services coordinates additional volunteer and service learning opportunities for international students.

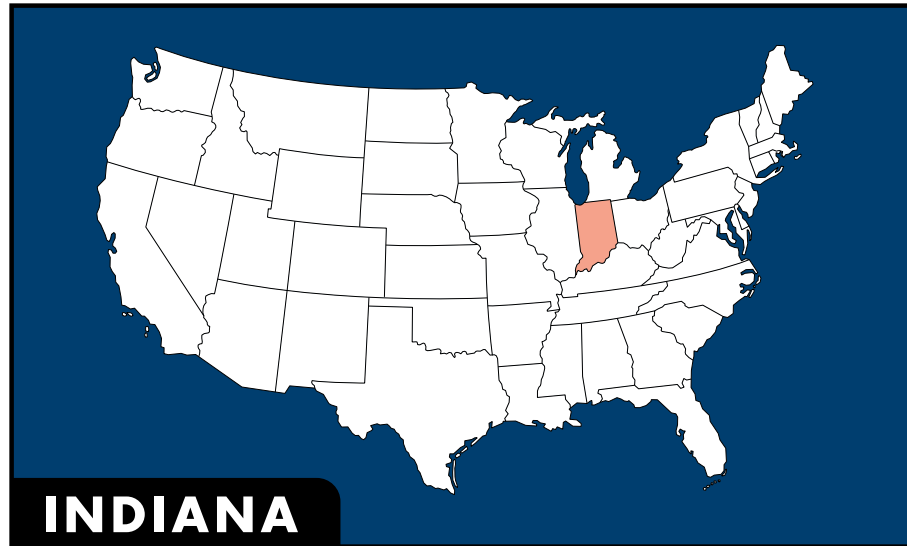
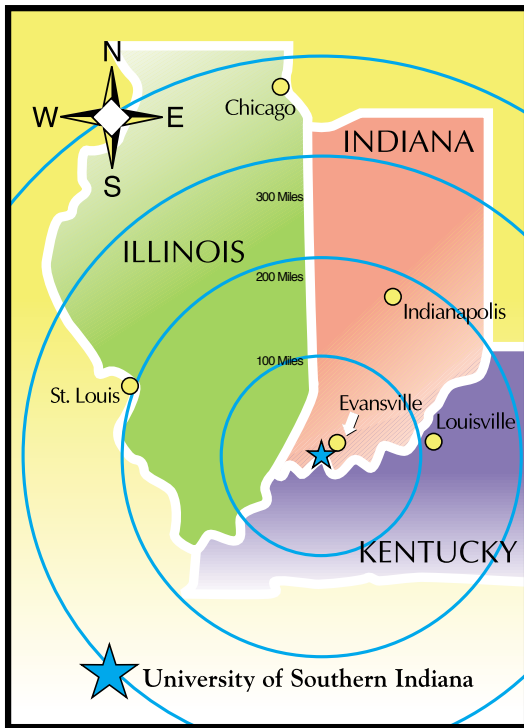

Evansville – Location is everything

Indiana—the American heartland

The University of Southern Indiana is located in the midwestern state of Indiana, which is called “The Crossroads of America” because of its central location in the country. About six million people live in Indiana.

The capital of the state is Indianapolis, home of the famous Indianapolis 500 automobile race. Indiana is an important farming and manufacturing state and is rich in natural resources, including coal and limestone.

Evansville—the best, smartest and All-American

Situated on the banks of the Ohio River, Evansville is Indiana’s third largest city. While the city offers many urban attractions, it retains the friendliness and charm of a smaller town. Evansville offers a lower cost of living and a much lower crime rate than major U.S. cities.

Evansville has been listed among the “100 Best Communities for Young People” by America’s Promise Alliance and was named an All-America City by the National Civic League. Kiplinger’s Personal Finance selected Evansville as 1 of 50 “Smartest Cities in Which to Live.”

Economy

Southwestern Indiana is an important farming and manufacturing region. Stretches of fertile land produce corn, soybeans and other crops. Over the years, Evansville has been home to major commercial endeavors, including steel, automotive and plastics industries. Some of the major manufacturing companies in the region today are Toyota Motor Manufacturing Indiana, Inc., Mead Johnson Nutritionals, Berry Plastics, SABIC Innovative Plastics, A.K. Steel and Aluminum Company of America (ALCOA). Evansville also is a regional center for healthcare.





EVANSVILLE, INDIANA

Population:

City – 117,000 persons:

Metropolitan area – 358,000 persons

Average Temperature:

Vast range

Average annual rainfall:

42 inches

Average annual snowfall:

10 inches

Time Zone:

Central

Summer: GMT-5, Winter: GMT-6

Getting around the city

The Metropolitan Evansville Transit System (METS) operates bus service in the metropolitan area. The service is available to major shopping and cultural destinations in the city and, on a limited basis, to the University of Southern Indiana campus.

Many students find that having a personal car makes it convenient for them to access the services they need in the area and the activities they want to attend off-campus.

Climate

Southwestern Indiana has four distinct seasons. Students should plan clothing for changing seasons. The climate is humid with cool winters and warm summers.

So much to enjoy in the city and around the area

The city of Evansville is an active community with many recreational and cultural activities. Spacious parks in the area include the 140-acre Burdette Park near USI. The Pigeon Creek Greenway Passage offers walking and biking trails, including a segment downtown overlooking the scenic Ohio River. Students often meet friends at concerts, restaurants, coffee shops, movie theatres (including an IMAX) or the ice arena.

Cultural opportunities include the Evansville Museum of Arts, History and Science. The

Evansville Philharmonic Orchestra performs downtown in the restored Victory Theatre. Well-known entertainers and traveling shows also come to Evansville.

Evansville also is home to the Evansville Otters, a professional baseball team in the Frontier League. From 1995 until the present, the Otters have played their home games at Bosse Field, the third-oldest ballpark used for professional baseball in the country.

The Evansville IceMen, a professional hockey team in the Central Hockey League, also make their home in Evansville, playing their home games downtown at the Ford Center, designed by the renowned sports facility architectural firm Populous.

A thriving commercial center, Evansville has two shopping malls: Eastland Mall, with three department stores, a food court, and over 100 specialty stores; and Washington Square Mall, the oldest enclosed shopping center in Indiana. There also are a number of other shopping centers featuring supermarkets, large discount stores and smaller retailers.

Evansville is a two- to three-hour drive to a number of major U.S. cities, including Indianapolis, Indiana; St. Louis, Missouri; Nashville, Tennessee; Cincinnati, Ohio; and Louisville, Kentucky.



Admission procedures and deadlines

International applications are accepted on a rolling basis throughout the year. An international student should apply well in advance of the semester in which he or she plans to enter.

For additional assistance with the application process and information specific to your country, contact the nearest EducationUSA Center.

For more information on EducationUSA, and to find the Center closest to you, visit the website at www.educationusa.info.

Exchange students participating in an established exchange program between their home institution and the University of Southern Indiana should contact the international office at their institution to apply for the program.

Freshman admission checklist

www.usi.edu/admission/international-students

- Completed International Student Application form (online application) and a copy of your passport/visa with the \$40 application fee



- Official transcript of all secondary schools and universities (with graduation date), plus English translation
- Official (photocopy not acceptable) TOEFL (Test of English as a Foreign Language) score report verifying a minimum total score of 525 (paper test) or 71 (Internet-based test), PTE, EIKEN, ELS completion of level 12, or official IELTS (International English Language Testing System) score report verifying a minimum score of 6. The TOEFL code for USI is 1335. If English is your native language, USI requires either the ACT or SAT score instead of one of the above tests.
- Completed International Student Statement of Finances form and a certified bank statement
- Students transferring from another U.S. institution also must submit an International Student Transfer Form.

Send undergraduate supporting documents to:

International Admission
University of Southern Indiana
8600 University Boulevard
Evansville, Indiana 47712 U.S.A.
enroll@usi.edu

Graduate admission

The following standards have been established for regular admission to a program of graduate study leading to the master's degree. (Some programs require a higher GPA. Check the specific program description.)

1. Graduation with a bachelor's degree (minimum cumulative GPA 2.5) from a college or university accredited by the North Central Association of Colleges and Secondary Schools or a comparable association
2. A minimum grade point average of 3.0 in all courses taken at the graduate level at all schools attended
3. An undergraduate record which provides adequate preparation to begin graduate study
4. Certain programs require satisfactory performance on the Graduate Record Examination, National Teacher Examination, PRAXIS I score results or Graduate Management Admissions Test
5. Any other requirements for admission which have been established for a specific program and approved by the Graduate Council

Checklist

www.usi.edu/gradstud/appl.asp

- A completed Graduate Admission Application (online or paper application) and \$40 application fee
- Official transcripts or certified true copy of all grade reports, diplomas, degree certificates and academic records from each undergraduate and graduate institution attended (with English translation)
- Official TOEFL score of 550 (paper test) or 79 on Internet-based test, or 6 on the IELTS test, PTE, EIKEN, ELS
- A completed International Student Statement of Finances form and a certified bank statement
- Satisfactory performance on the Graduate Record Examination, National Teacher Examination or Graduate Management Admissions Test when required by the program
- Students transferring from another U.S. institution also must submit an International Student Transfer Form

Test of English as a Foreign Language (TOEFL)

Information about the TOEFL dates and registration procedures may be obtained from: www.ets.org/toefl.

Immigration policies

International students on F-1 or J-1 visas are required to enroll in a full-time course of study during their academic program. Undergraduate students must enroll in a minimum of 12 credit hours per semester; graduate students must take at least nine credit hours per semester. International students may work on campus up to 20 hours per week during the academic year and full-time during vacation periods. Employment off-campus is not permitted unless the student has obtained authorization from Immigration after maintaining F-1 status for a minimum of one academic year. Exchange visitors on J-1 visas should check with their program sponsors regarding specific regulations for their program.

Information on applying for a student visa is available from the U.S. Department of State website at travel.state.gov/visa/temp/types/types_1270.html.

Further information on immigration regulations affecting international students is available on the USI website at www.usi.edu/international/internationalstudents/immigrationregulations.aspx.

Transfer credit

In order for transfer credit to be granted at USI, the foreign education institution must be recognized by the Ministry of Education (or other accrediting body) of the respective country and must correspond in both content and credit value to one in our curriculum. Your post-secondary transcripts from recognized institutions will automatically be considered for credit once you are admitted to USI. Please be sure to send in detailed course syllabi for each course to expedite the review process. Advanced credit also may be given for British GCE Advanced Levels upon receipt of the official certificate.

IB Credit

USI will recognize most Higher Level (HL) and some Standard Level (SL) credit earned through the International Baccalaureate Program. A minimum grade of 5 (good) is required. To be considered for credit, the official exam results must be mailed directly from IB to USI.

AP Credit

USI grants advanced credit for many AP exam results with minimum scores between 3-5 depending on the exam subject. For a current listing, visit our website at www.usi.edu/registrar/classes/credit-by-exam.



The Intensive English Program at USI

Through classroom instruction and cultural programming, the Intensive English Program at the University of Southern Indiana helps non-native speakers of English develop the skills to succeed in university academic programs. Students in the Intensive English Program are integrated into the academic, social and cultural life of the University with opportunities to interact with other USI students in residence halls, dining facilities, student organizations and campus events. Program staff also provide students with academic, personal and immigration advising and counseling.

Intensive English Program (IEP):

- The intensive English Program offers five eight-week sessions year-round, beginner-to-advanced level of English proficiency
- Specialized classes based on future major of interest (business, English, nursing, engineering, TOEFL preparation, etc.)
- Small class size gives you one-on-one time with caring, highly qualified instructors
- Student-centered collaborative learning environment

IEP Services:

- Conditional admission without TOEFL
- Affordable
- Orientation process to guide students from the first day
- Assistance with visa process
- Airport pick up
- Modern, beautiful campus with apartment-style housing.
- Participate in student life with international club events, conversation partners, host families, writing lab and more.
- Access University facilities and resources such as fitness center, dining, busses and library.

IEP Calendar:

- Terms begin in August, October, January, March and May.
- Six levels
- 1-23 hours/week

www.usi.edu/iep



Campus living

Convenience, safety, support

More than 2,800 students live in USI housing—near classes, the library, friends and campus activities. USI’s modern campus accommodations are extremely popular with students.

A staff of housing professionals and student resident assistants helps students adjust to independent living and make the most of their college experience outside the classroom. Students living on campus enjoy easy access to academic and recreational facilities, and a campus convenience store serves their needs. USI Public Safety is on duty 24 hours a day.

Two styles of campus housing

The University offers two types of accommodations—apartments and suite-style residence halls.

Campus Apartments

Each traditional apartment offers a kitchen, dining area, living room, two bathrooms and two bedrooms. Apartments are fully furnished and include a full-size refrigerator and stove. The apartments have exterior corridors. A select number of apartments are designed with private bedrooms. Availability of apartments with private bedrooms is limited.

Residence halls

The residence halls offer furnished suites with two bedrooms, two bathrooms, a living space and—instead of a complete kitchen—a snack area with sink, under-counter refrigerator and cupboards. All students living in residence halls participate in the meal plan available in the University Center dining facility.

Residence halls have a central entrance, a reception area and access to suites from interior corridors.

Residence halls appeal to many students because they provide both independence and common areas where students can meet each other and spend time together.

Housing amenities

No matter which housing style you choose, you get these benefits:

- air conditioning
- access to USI network and Internet through ethernet card or wireless network
- cable connections
- computer labs
- local phone service
- laundry facilities
- within delivery range of several area restaurants

Campus Apartment



Residence Hall

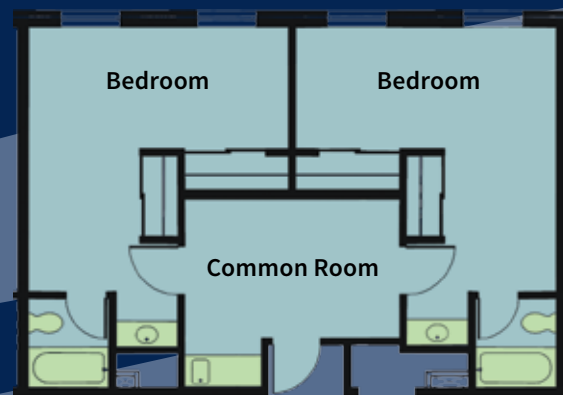



Residence Life

The Residence Life program offers living-learning communities for students who share similar interests and academic programs. Participants live in designated wings of the residence halls with special programs and services including a seminar class. Students may select from nine living-learning communities: business, education, exploring majors, global community, honors, liberal arts, nursing and health professions, social work and STEM (science, technology, engineering and mathematics). With the exception of the Global Community LLC, students must be freshmen to participate in these communities.

Global Community

The Global Community wing is available for American and international students who want to broaden their international knowledge and experience. The Global Community features monthly programs and events designed to celebrate the world's diversity and to explore some of the complex issues that global citizens need to understand. Culture nights provide students the opportunity to share information about their homeland, its traditions and culture. Other events focus on international issues, such as the environment or conflict resolution. In addition, the Global Community co-sponsors several day trips throughout the year that help international students to bond, participate in fun and educational events, see more of the Midwest and increase their understanding of U.S. culture. The Global Community allows friendships to develop along with respect and appreciation for the world at large, while celebrating our colorful diversity. For more information, you can visit the website: www.usi.edu/international/gettinginvolved/globalcommunity.aspx.



Center for International Programs (CIP)

The Center for International Programs and Services (CIP) assists international and American students in a variety of ways related to the international dimensions of their education. As the central unit on campus for matters concerning international students, CIP helps students adjust to the University and the Evansville community and provides support services to ensure that each student's educational experience is successful.

CIP provides information and assistance with:

- orientation and adjustment
- immigration policies and procedures
- academic concerns
- personal problems
- financial emergencies
- professional concerns
- reentry issues
- culture shock
- employment procedures

Programs for the entire international community are designed to enhance each student's academic experience and to help all students learn more about each other and the world in which they live. More information can be found through the CIP's website (www.usi.edu/international) or Facebook page (www.facebook.com/USI.InternationalPrograms).



Ongoing programs include the following:

Host Family Program

The Host Family Program encourages interaction between international students and families connected with the University. Casual social occasions (dinner, sports activities, holiday visits, etc.) offer opportunities for international students and American families to get together for friendship and relaxation.

International Outreach Program

The International Outreach Program provides international students with the opportunity to share their culture and language with American community groups, school children and area businesspersons.

Small World Program

Small World is a program that pairs American students with international students to broaden their horizons by spending time together socially and learning more about each other's culture. The program is a bridge between cultures, and quite often long-lasting friendships develop between partners.

International Connections

International Connections is an orientation program to help new international students with their initial adjustment to campus and the surrounding area. Center for International Programs staff meet students upon their arrival in Evansville. All new international students are required to participate in this comprehensive orientation and registration program during the week prior to the fall and spring semesters. The activities include many opportunities to meet other students.

Additional Opportunities

Many international programs, such as the International Week festivities, are sponsored in cooperation with the International Club and other campus organizations. The Global Community's monthly cultural and social events are open to the entire campus community. The Center for International Programs also organizes trips to places of interest in the region such as Chicago, Illinois, and St. Louis, Missouri.



Athletics

The University of Southern Indiana is a top competitor in the Great Lakes Valley Conference of the National Collegiate Athletics Association Division II. In this division, USI has won three national championships (men's basketball in 1995, and baseball in 2010 and 2014), has finished three times as a national finalist in basketball (men's in 1994 and 2004, and women's in 1997), and has had two third place finishes (men's cross country in 1982, and baseball in 2007). The women's basketball and softball teams both ranked in the top 20 nationally in team GPA.

International students interested in trying out for a team should find the contact information for the appropriate staff member on the athletics website, www.gousieagles.com/staff.aspx.



Intercollegiate sports

Men's

- Baseball
- Basketball
- Cross Country
- Golf
- Soccer
- Tennis
- Indoor Track and Field
- Outdoor Track and Field

Women's

- Basketball
- Cross Country
- Golf
- Soccer
- Softball
- Tennis
- Volleyball
- Indoor Track and Field
- Outdoor Track and Field



Other Opportunities

Club sports allow students to compete against teams from other colleges and universities without having to play at the NCAA division level. Club sports include rugby, Ultimate Frisbee and Quidditch. Students also can participate in a wide variety of athletic activities through the Intramurals program throughout the year.





Getting involved on campus

Student Life

USI provides an ideal environment for students to get involved beyond the classroom. Students use the University Center, the expansive campus and the recreational facilities to get together informally or to participate in intramurals, campus organizations or other activities. Cultural activities include theatre, musical events and presentations by recognized speakers and performers.

The heart of recreation activity on campus is the newly expanded Recreation, Fitness and Wellness Center which features:

- Personal trainers and nutrition advisors
- Cardio training machines
- Free weights and strength machines
- Three-story rock-climbing wall
- Martial arts mat area
- Table tennis area
- Indoor walking/running track
- Three indoor basketball courts
- Two outdoor basketball courts
- Game room
- Exercise classes

More than 3,000 students take part each semester in Intramural programs. A wide range of structured activities such as those below are available for participants of all levels and abilities.

- Whitewater rafting
- Caving trips
- Canoe and camping trips
- Ski trip
- Flag football
- Miniature golf
- Volleyball, Softball and Soccer
- Disc golf
- Basketball
- Tennis and Badminton

Campus organizations

The University has more than 130 campus clubs and organizations. For a full list of organizations, go to www.usi.edu/studentorganizations. USI has the following types of registered organizations:

- Academic/Professional
- Programming boards
- Political organizations
- Religious organizations
- Multicultural organizations (including the International Club)
- Special-interest organizations
- Service organizations
- Governing bodies
- Greek-letter organizations (seven fraternities and four sororities)

Other opportunities

- AMIGO orientation assistants
- First Year Initiatives
- USI Chamber Choir
- O'Daniel Leadership Academy
- *The Shield* (campus newspaper)
- USI Theatre
- University committees
- WSWI Radio Station

International Club

The International Club brings together students of all ethnic backgrounds to promote intercultural understanding and friendship. Members participate in a number of social, cultural and educational activities and outings throughout the year, including trips to nearby cities, fall and spring break trips and fun activities after each monthly meeting. One of the most popular events is the annual International Food Expo with food and entertainment representative of many countries. The club provides a support system and leadership opportunities for students and makes a considerable impact on the campus and community.



How to get to the University of Southern Indiana

Airport connections

Students should book a flight to Evansville Regional Airport (EVV). Notify the Center for International Programs of your flight schedule. A campus representative will meet you at the airport and escort you to campus or to your accommodations.

Taxi service also is available from the airport to campus. The distance is about 15 miles, and the trip will take about 20 minutes, depending on the time of day and traffic.

By bus

Students coming from another U.S. city by bus will arrive at the bus terminal in downtown Evansville. If you notify the Center for International Programs of your schedule, a campus representative will meet you at the terminal and escort you to campus or to your accommodations.

The bus terminal is about seven miles east of the USI campus. Taxi service is available 24 hours a day.

By car

Evansville is easily accessible by several major routes from Chicago, Indianapolis, St. Louis, Louisville, Nashville and other cities which have international airports. When you arrive, be sure to come to the Center for International Programs so that we can welcome you to the University. The office is located on the lower level of the University Center East (see campus map).





CAMPUS MAP

AE	Applied Engineering Center	FC	Recreation, Fitness and Wellness Center	PP	Physical Plant Service Center	TC	Technology Center	STUDENT HOUSING	
AS	Art Studio	FO	USI Foundation	PUB	Publishing Services Center, including Copy Center and Photography Services	TN	Tennis Courts	1-22	O'Daniel Apartments
BE	Business and Engineering Center	HP	Health Professions Center, including IU School of Medicine-Evansville, and Mitchell Auditorium	RC	Residence Life Community Center	TS	Theatre Support Center	23-44	McDonald Apartments
BF	Baseball Field	LA	Liberal Arts Center, including Kleymeyer Hall, Maillette Studio Theatre, and McCutchan Art Center/Pace Galleries	RES	Fair Residence Life Center	UC-E	University Center East	45	Newman Hall
BT	Bent Twig Outdoor Education Center	OC	Robert D. Orr Center	RS	Residence Life Service Center	UC-W	University Center West, including Carter Hall	46	Governors Hall
BW	Broadway Sports Complex	PF	Performance Center	RL	David L. Rice Library	WA	Byron C. Wright Administration Building	47	O'Bannon Hall
CN	Dowhe Ceramics Center	PA	Physical Activities Center (PAC)	PS	Public Safety Building, including Parking Department			48	Ruston Hall
CC	Children's Learning Center			SF	Strassweg Soccer Field			UNDER CONSTRUCTION	
DG	Disc Golf Course			SS	Support Services Center			GC	The Griffin Center
ED	Education Center								
FA	Forum Wing, including Forum Lecture Halls FA-1, 2 and 3								



FOR MORE INFORMATION

ADMISSION

812-464-1765 or toll free 800-467-1965 (valid in U.S.) • 812-465-7154/fax • i.apply@usi.edu

CENTER FOR INTERNATIONAL PROGRAMS

812-465-1248 • 812-228-5097/fax • intlprog@usi.edu

GRADUATE STUDIES

812-465-7015 • gradstudies@usi.edu

INTENSIVE ENGLISH PROGRAM

812-461-5365 • 812-228-5110/fax • usi1iep@usi.edu



8600 University Boulevard | Evansville, Indiana 47712 | [USI.edu](http://usi.edu)

It is the policy of the University of Southern Indiana to be in full compliance with all federal and state non-discrimination and equal opportunity laws, orders, and regulations relating to race, sex, religion, disability, age, national origin, sexual orientation or veteran status. Questions or concerns should be directed to the Affirmative Action Officer, USI Human Resources Department, University of Southern Indiana, 8600 University Boulevard, Evansville, Indiana 47712.